

*Courses and Distances
down the
Clearfield Creek*

S. 80.	E. 10.
N. 55.	E. 76.
S. 72.	E. 132.
N. 27.	N. 146.
N. 86.	E. 122.
N. 07 th	82.
N. 56.	N. 200
	<u>768</u>

Charles Smith's Land

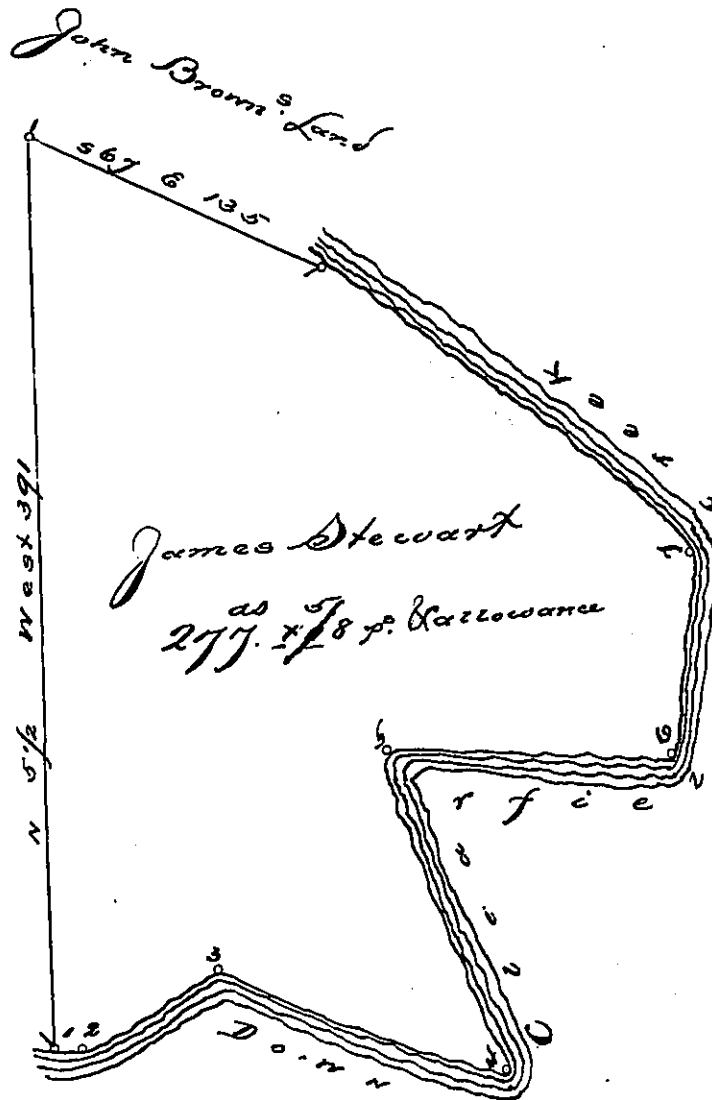

*A Draught of a Tract of Land Situate on Clearfield Creek Bedford County.
Containing 277 acres & one hundred eight perches & the usual allowance of six sp.
Sent &c. Surveyed the 15th of Apr^l 1785. in pursuance of a Warrant dated the
10th Day of March 1785.*

George Woods D.D.

*To John Lukens Esq
D.D.*

*IN TESTIMONY that the above is a copy of the original remaining on file in
the Department of Internal Affairs of Pennsylvania, made
conformably to an Act of Assembly approved the 16th day of
February, 1833, I have hereunto set my Hand and caused
the Seal of said Department to be affixed at Harrisburg,
this third day of May, 1898,*

James W. Patton
Secretary of Internal Affairs.